

Port Standards: SAE J-1926-1 / ISO 11926-1, and MS-16142

Item Numbers

Tube Dash No.	Port Thread Size	Port Contour Cutter Number	T-A® Drill Item Numbers				Port Form Insert Item Numbers			
			Super Cobalt GEN2 T-A™ (AM200®)	Carbide GEN2 T-A™ (AM200®)	Torx Plus® Screw	Torx Plus® Driver	P40 Carbide (TiAlN)	New K10 Carbide (AM200®)	Torx Plus® Screw	Torx Plus® Driver
- 4	7/16-20 UNF-2B	J1926-04Y-16FM	45YH-.386	4C1YH-.386	724-IP7	8IP-7	J1926-02-C5A	J1926-02-C3H	72556-IP8	8IP-8
- 5	1/2-20 UNF-2B	J1926-05Z-16FM	45ZH-11.5	4C1ZH-11.5	7247-IP7	8IP-7	J1926-02-C5A	J1926-02-C3H	72556-IP8	8IP-8
- 6	9/16-18 UNF-2B	J1926-06O-20FM	45OH-13	4C1OH-13	72556-IP8	8IP-8	J1926-02-C5A	J1926-02-C3H	72556-IP8	8IP-8
- 8	3/4-16 UNF-2B	J1926-08O-20FM	45OH-0022	4C1OH-0022	72567-IP8	8IP-8	J1926-07-C5A	J1926-07-C3H	72556-IP8	8IP-8
- 10	7/8-14 UNF-2B	J1926-10I-25FM	45IH-20.5	4C1IH-20.5	7375-IP9	8IP-9	J1926-07-C5A	J1926-07-C3H	72556-IP8	8IP-8
- 12	1 1/16-12 UN-2B	J1926-122-32FM	452H-25	4C12H-25	7495-IP15	8IP-15	J1926-08-C5A	J1926-08-C3H	7375-IP9	8IP-9
- 14	1 3/16-12 UN-2B	J1926-142-32FM	452H-28	4C12H-28	7495-IP15	8IP-15	J1926-08-C5A	J1926-08-C3H	7375-IP9	8IP-9
- 16	1 5/16-12 UN-2B	J1926-162-32FM	452H-31	4C12H-31	7495-IP15	8IP-15	J1926-08-C5A	J1926-08-C3H	7375-IP9	8IP-9
- 20	1 5/8-12 UN-2B	J1926-203-32FM	453H-39	1C53A-39	7514-IP20	8IP-20	J1926-10-C5A	J1926-10-C3H	7375-IP9	8IP-9
- 24	1 7/8-12 UN-2B	J1926-243-150F	453H-45.5	1C53A-45.5	7514-IP20	8IP-20	J1926-10-C5A	J1926-10-C3H	7375-IP9	8IP-9
- 32	2 1/2-12 UN-2B	J1926-324-150F	454H-61.5	N/A	7514-IP20	8IP-20	J1926-12-C5A	J1926-12-C3H	7375-IP9	8IP-9

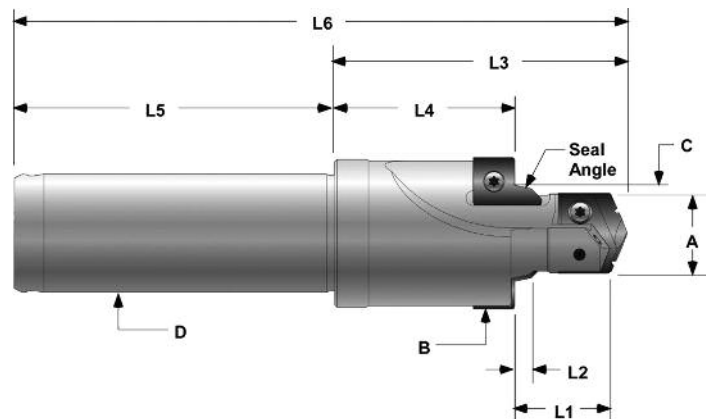

Dimensions

Tube Dash No.	Port Thread Size	Port Contour Cutter Number	Stk.	A	L1	B	Seal Angle	C	L2	L3	L4	D	L5	L6
				Minor Dia.	Minor Dia Length	Spotface Dia. W/ridge		Seal Angle Dia.	Seal Angle Length	Reference Length	Spot face to Shoulder Length	Shank Dia.	Shank Length	OAL
- 4	7/16-20 UNF-2B	J1926-04Y-16FM	●	9.8	14.0	21.4	12°	12.5	2.7	38.8	22.8	16	47.6	86.4
- 5	1/2-20 UNF-2B	J1926-05Z-16FM	●	11.5	14.0	23.0	12°	14.1	2.7	38.8	22.4	16	47.6	86.4
- 6	9/16-18 UNF-2B	J1926-06O-20FM	●	13.0	15.5	24.6	12°	15.7	2.7	47.2	29.0	20	51.6	98.8
- 8	3/4-16 UNF-2B	J1926-08O-20FM	●	17.5	17.5	30.7	15°	20.7	2.7	50.3	29.2	20	51.6	101.1
- 10	7/8-14 UNF-2B	J1926-10I-25FM	●	20.5	20.0	34.0	15°	24.0	2.7	54.4	30.1	25	57.9	112.3
- 12	1 1/16-12 UN-2B	J1926-122-32FM	●	25.0	23.0	42.1	15°	29.2	3.5	67.1	38.9	32	57.9	125.0
- 14	1 3/16-12 UN-2B	J1926-142-32FM	●	28.0	23.0	45.3	15°	32.4	3.5	67.1	38.2	32	57.9	125.0
- 16	1 5/16-12 UN-2B	J1926-162-32FM	●	31.2	23.0	48.5	15°	35.6	3.5	67.1	37.5	32	57.9	125.0
- 20	1 5/8-12 UN-2B	J1926-203-32FM	●	39.0	23.0	58.7	15°	43.6	3.5	77.8	46.6	32	57.9	146.0
- 24	1 7/8-12 UN-2B	J1926-243-150F	●	45.5	23.0	65.0	15°	49.9	3.5	77.8	45.2	38.1	68.3	146.0
- 32	2 1/2-12 UN-2B	J1926-324-150F	●	61.5	23.0	88.0	15°	65.8	3.5	96.8	60.8	38.1	68.3	165.1



AccuPort 432®

Port Standards: SAE J-1926-1/ISO 11926-1, and MS-16142 with extended minor diameter lengths (L1)

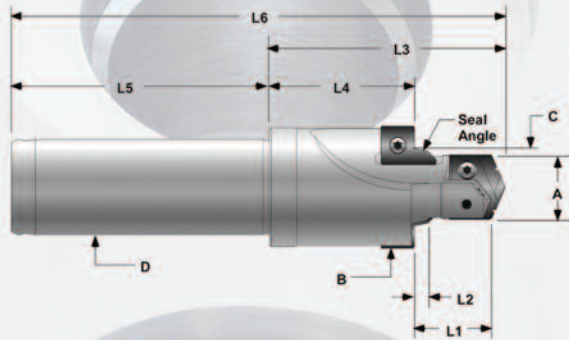

Dimensions

Tube Dash No.	Port Thread Size	Port Contour Cutter Number	Stk.	A	L1	B	Seal Angle	C	L2	L3	L4	D	L5	L6
				Minor Dia.	Minor Dia. Length	Spotface Dia. W/ridge		Seal Dia.	Seal Angle Length	Reference Length	Spotface to Shoulder Length	Shank Dia.	Shank Length	OAL
- 4	7/16-20 UNF-2B	X1926-04Y-063F	○	9.8	20.3	21.4	12°	12.5	2.7	45.1	22.8	15.9	47.6	92.8
- 5	1/2-20 UNF-2B	X1926-05Z-063F	○	11.5	20.3	23.0	12°	14.1	2.7	45.1	22.4	15.9	47.6	92.8
- 6	9/16-18 UNF-2B	X1926-060-075F	○	13.0	21.8	24.6	12°	15.7	2.7	53.5	29.0	19.1	50.0	103.5
- 8	3/4-16 UNF-2B	X1926-080-075F	○	17.5	23.8	30.7	15°	20.7	2.7	56.7	29.2	19.1	50.0	106.7
- 10	7/8-14 UNF-2B	X1926-101-100F	○	20.5	26.3	34.0	15°	24.0	2.7	60.7	30.1	25.4	57.9	118.6
- 12	1 1/16-12 UN-2B	X1926-122-125F	○	25.0	29.3	42.1	15°	29.2	3.5	73.4	38.9	31.8	57.9	131.3
- 14	1 3/16-12 UN-2B	X1926-142-125F	○	28.0	29.3	45.3	15°	32.4	3.5	73.4	38.2	31.8	57.9	131.3
- 16	1 5/16-12 UN-2B	X1926-162-125F	○	31.2	29.3	48.5	15°	35.6	3.5	73.4	37.5	31.8	57.9	131.3
- 20	1 5/8-12 UN-2B	X1926-203-150F	○	39.0	29.3	58.7	15°	43.6	3.5	84.1	46.6	38.1	68.3	152.4
- 24	1 7/8-12 UN-2B	X1926-243-150F	○	45.5	29.3	65.0	15°	49.9	3.5	84.1	45.2	38.1	68.3	152.4
- 32	2 1/2-12 UN-2B	X1926-324-150F	○	61.5	29.3	88.0	15°	65.8	3.5	103.2	60.8	38.1	68.3	171.4

Made to order tool specifications – Priced on Request

Fax a copy of the table below to the AMEC's Application Engineering Department on +44 1384 408372 or email (engineering@alliedmaxcut.com) to receive pricing for a made to order AccuPort 432® Port Contour Cutter.

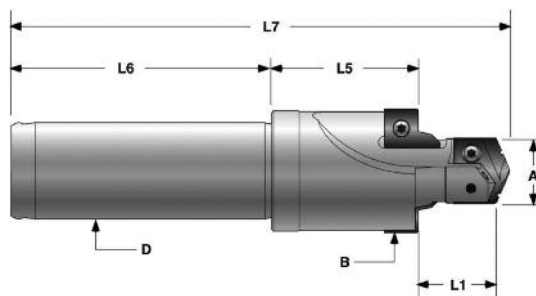

Tube Dash Number	Specification	Port Thread Size	A	L1	B	L5	D	L6	L7
			Minor Dia.	Minor Dia. Length	Spotface Dia.	Spotface to Shoulder Length	Shank Dia.	Shank Length	OAL
	<input type="checkbox"/> J1926 <input type="checkbox"/> ISO 6149 <input type="checkbox"/> AS5202 <input type="checkbox"/> ISO 6149 (without ridge)	Min. Max.							
Company Name		Contact Name			Telephone				
Distributor					Fax				

Port Standards: SAE AS5202 (Formerly UNJF-30 MilSpec MS-33649)
 Also conforms to UNF AND10050 Using Alternate Tap Drill Diameter (shaded areas)

Item Numbers

Tube Dash No.	Port Thread Size	Port Contour Cutter Number	T-A® Drill Item Numbers				Port Form Insert Item Numbers		
			Super Cobalt GEN2 T-A™ (AM200°)	Carbide GEN2 T-A™ (AM200°)	Torx Plus® Screw	Torx Plus® Driver	C5 Carbide (TiAlN)	Torx Plus® Screw	Torx Plus® Driver
- 4	7/16-20 UNJF-3B	AS5202-04Y-063F	45YH-.390	4C1YH-.390	724-IP7	8IP-7	AS5202-04-C5A	72556-IP8	8IP-8
	7/16-20 UNF		45YH-.386	4C1YH-.386					
- 5	1/2-20 UNJF-3B	AS5202-05Z-063F	45ZH-11.5	4C1ZH-11.5	7247-IP7	8IP-7	AS5202-05-C5A	72556-IP8	8IP-8
	1/2-20 UNF-3B		45ZH-.451	4C1ZH-.451					
- 6	9/16-18 UNJF-3B	AS5202-06Z-075F	45ZH-.510	4C1ZH-.510	7247-IP7	8IP-7	AS5202-06-C5A	72556-IP8	8IP-8
	9/16-18 UNF-3B		45ZH-.506	4C1ZH-.506					
- 8	3/4-16 UNJF-3B	AS5202-080-075F	450H-17.5	4C10H-17.5	72567-IP8	8IP-8	AS5202-08-C5A	72556-IP8	8IP-8
	3/4-16 UNF-3B		450H-0022	4C10H-0022					
- 10	7/8-14 UNJF-3B	AS5202-101-100F	451H-20.5	4C11H-20.5	7375-IP9	8IP-9	AS5202-10-C5A	7495-IP15	8IP-15
	7/8-14 UNF-3B		451H-.801	4C11H-.801					
- 12	1 1/16-12 UNJ-3B	AS5202-122-125F	452H-25	4C12H-25	7495-IP15	8IP-15	AS5202-12-C5A	7495-IP15	8IP-15
	1 1/16-12 UN-3B		452H-.976	4C12H-.976					
- 14	1 3/16-12 UNJ-3B	AS5202-142-125F	452H-1.109	4C12H-1.109	7495-IP15	8IP-15	AS5202-14-C5A	7495-IP15	8IP-15
	1 3/16-12 UN-3B		452H-28	4C12H-28					
- 16	1 5/16-12 UNJ-3B	AS5202-162-125F	452H-1.234	4C12H-1.234	7495-IP15	8IP-15	AS5202-16-C5A	7495-IP15	8IP-15
	1 5/16-12 UN-3B		452H-1.226	4C12H-1.226					
- 20	1 5/8-12 UNJ-3B	AS5202-203-150F	453H-1.547	1C53A-1.547	7514-IP20	8IP-20	AS5202-20-C5A	7495-IP15	8IP-15
	1 5/8-12 UN-3B		453H-39	1C53A-39					
- 24	1 7/8-12 UNJ-3B	AS5202-243-150F	453H-1.797	1C53A-1.797	7514-IP20	8IP-20	AS5202-24-C5A	7495-IP15	8IP-15
	1 7/8-12 UN-3B		453H-45.5	1C53A-45.5					
- 32	2 1/2-12 UNJ-3B	AS5202-324-150F	454H-61.5	N/A	7514-IP20	8IP-20	AS5202-32-C5A	7495-IP15	8IP-15
	2 1/2-12 UN-3B		454H-2.413	N/A					

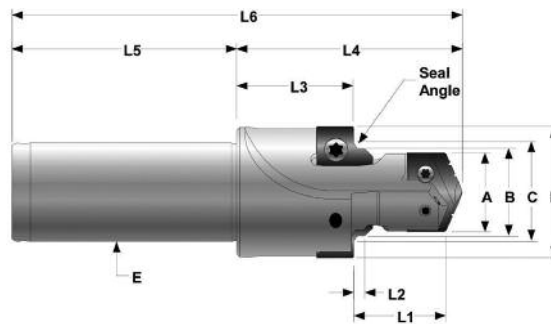

A1 = AND10050 Specifications

A2 = SAE AS5202 Specifications

Dimensions

Tube Dash No.	Port Thread Size	Port Contour Cutter Number	Stk.	A1	A2	L1	B	L2	Seal Angle	C	L2	L3	L4	D	L5	L6
				Dia.	Dia.	Minor Dia. Length	Pilot Dia	Pilot Length		Seal Angle Dia	Spot-face Dia	Spot-face to Shoulder Length	Total Head Length	Shank Dia	Shank Length	OAL
- 4	7/16-20 UNJF-3B	AS5202-04Y-063F	○	9.8	9.9	16.79	11.53	2.11	60	14.34	22.23	22.76	41.58	15.88	47.63	89.20
- 5	1/2-20 UNJF-3B	AS5202-05Z-063F	○	11.45	11.5	16.79	13.13	2.11	60	15.88	23.27	22.39	41.58	15.88	47.63	89.20
- 6	9/16-18 UNJF-3B	AS5202-06Z-075F	○	12.85	12.95	18.14	14.73	2.11	60	17.46	24.87	28.43	49.28	19.05	50.01	99.29
- 8	3/4-16 UNJF-3B	AS5202-080-075F	○	17.46	17.5	21.31	19.53	2.39	60	22.23	30.43	28.57	53.52	19.05	50.01	103.53
- 10	7/8-14 UNJF-3B	AS5202-101-100F	○	20.35	20.5	23.75	22.76	2.72	60	25.46	34.39	30.19	58.17	25.40	57.94	116.10
- 12	1 1/16-12 UNJ-3B	AS5202-122-125F	○	24.8	25.0	27.15	27.58	3.18	60	31.42	41.53	37.94	70.23	31.75	57.94	128.17
- 14	1 3/16-12 UNJ-3B	AS5202-142-125F	○	28.0	28.17	27.15	30.76	3.18	60	34.61	45.09	37.22	70.23	31.75	57.94	128.17
- 16	1 5/16-12 UNJ-3B	AS5202-162-125F	○	31.15	31.34	27.15	33.93	3.18	60	37.77	48.77	36.51	70.23	31.75	57.94	128.17
- 20	1 5/8-12 UNJ-3B	AS5202-203-150F	○	39.0	39.29	28.47	41.86	3.18	60	45.69	57.91	44.32	80.95	38.10	68.28	149.23
- 24	1 7/8-12 UNJ-3B	AS5202-243-150F	○	45.5	45.64	28.75	48.21	3.18	60	52.07	65.28	42.58	80.95	38.10	68.28	149.23
- 32	2 1/2-12 UNJ-3B	AS5202-324-150F	○	61.3	61.49	34.87	64.11	3.18	60	67.97	88.65	45.78	93.65	38.10	68.28	161.93

Stk. - Stock Availability.

- Stock Item.
- Stocked in limited quantities, advanced planning is recommended
- ◆ Non-Stocked Standard. Normal delivery 5 to 6 weeks